

STATE WHEN ORDERING

FW = mm
 FH = mm
 X = mm
 COW = mm
 COH = mm
 CL = mm

Surface treatment

☐ Silver anodized
 Special anodized
 RAL
 Special powder coating

Options see layers:

☐ Bottom rail 178
☐ Midrail 70, MH = mm
☐ Midrail 150, MH = mm

Glass option see drw. 1009026

Glass code:

Limitation

If 22 mm glass FW x FH = max. 11,3 m²
 If 40 mm glass FW x FH = max. 9,9 m²

Installation

☐ Floor heating
☐ Other

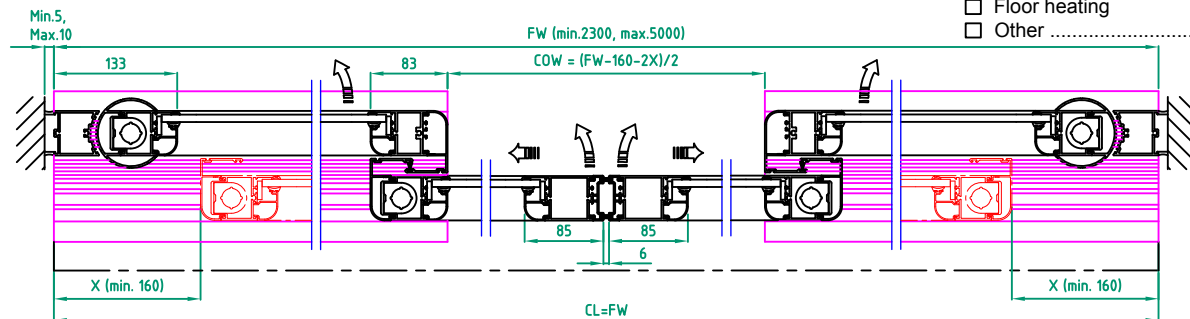

Customer:

Ref:

Door id:

Date:

Project No:

Sign:

Automatic door system
 ASSA ABLOY Frame break-out 4 Panel wall mounted
 Art. No. 1009382-4PB-15
 ASSA ABLOY SL500

ASSA ABLOY

6.0 1009382-EI

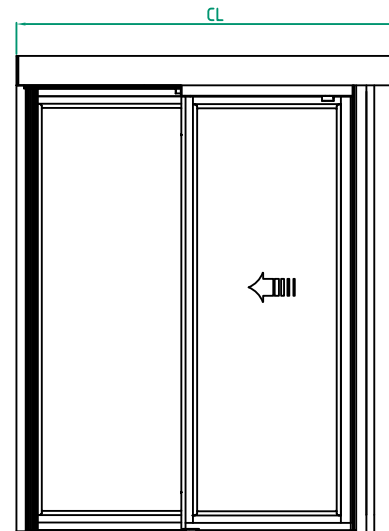
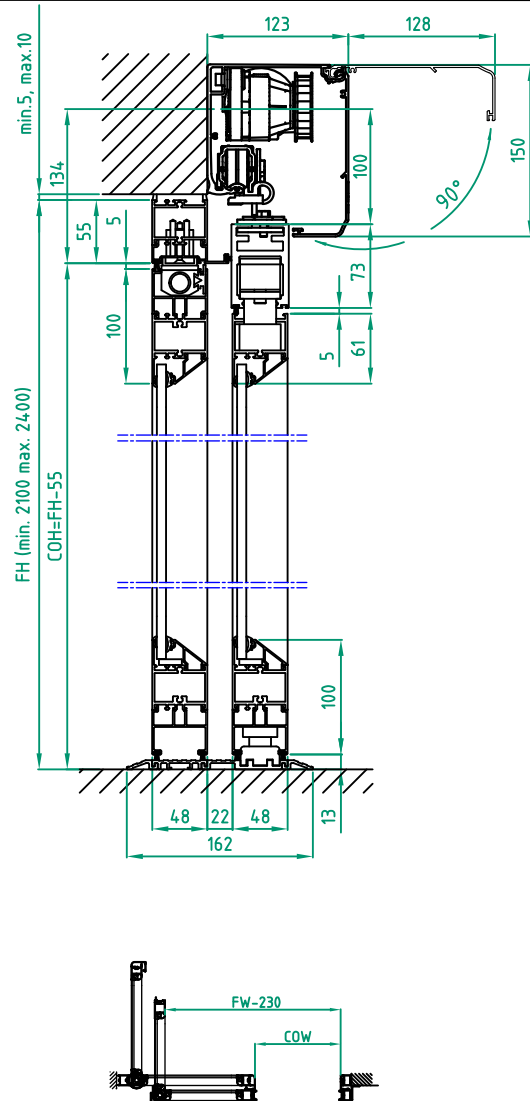

STATE WHEN ORDERING

FW = mm
FH = mm
X = mm
COW = mm
COH = mm
CL = mm

Surface treatment

☐ Silver anodized
Special anodized
RAL
Special powder coating
.....

Options see layers:

☐ Bottom rail 178
☐ Midrail 70, MH = mm
☐ Midrail 150, MH = mm

Glass option see drw. 1009026

Glass code:

Limitation

If 22 mm glass FW x FH = max. 5,8 m²
If 40 mm glass FW x FH = max. 5,1 m²

Installation

☐ Floor heating
☐ Other

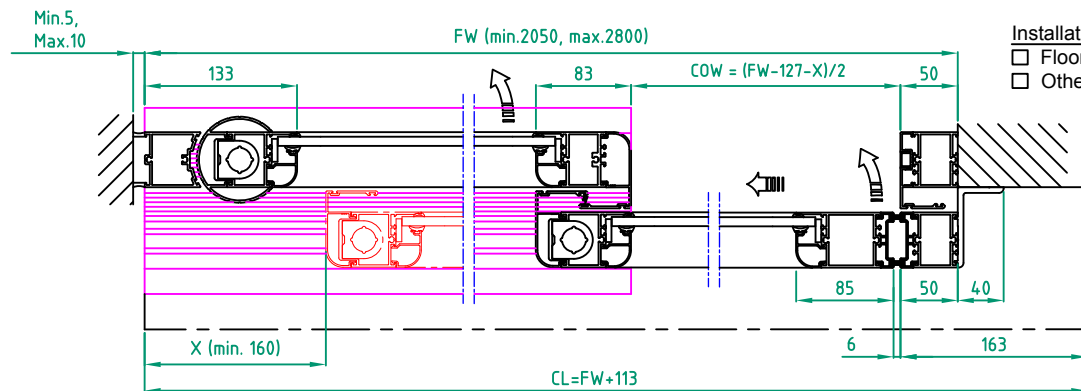

Customer:

Ref:

Door id:

Date:

Project No:

Sign:

Automatic door system
ASSA ABLOY Frame break-out 2 Panel wall mounted opening left
Art. No. 1009382-2PS-15
ASSA ABLOY SL500

ASSA ABLOY

6.0

1009382-EI

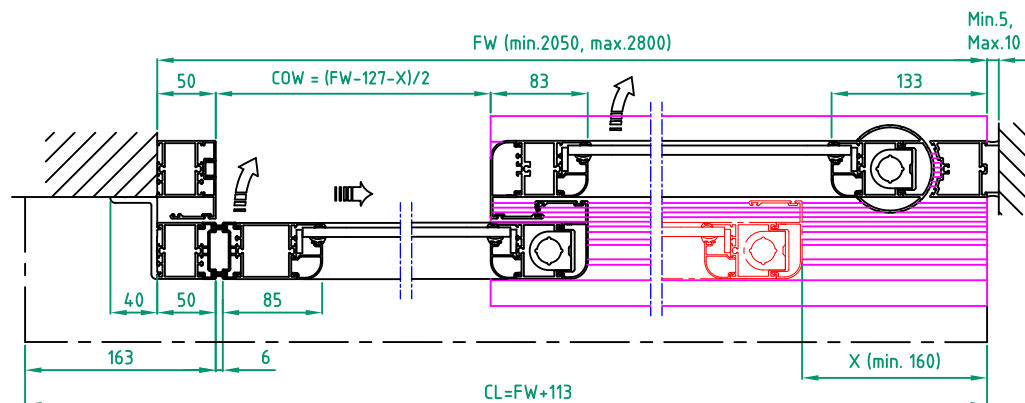
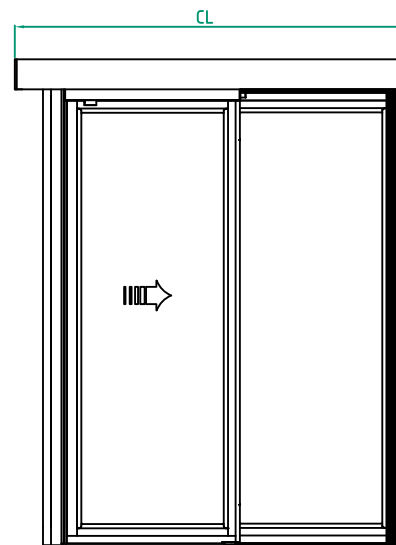
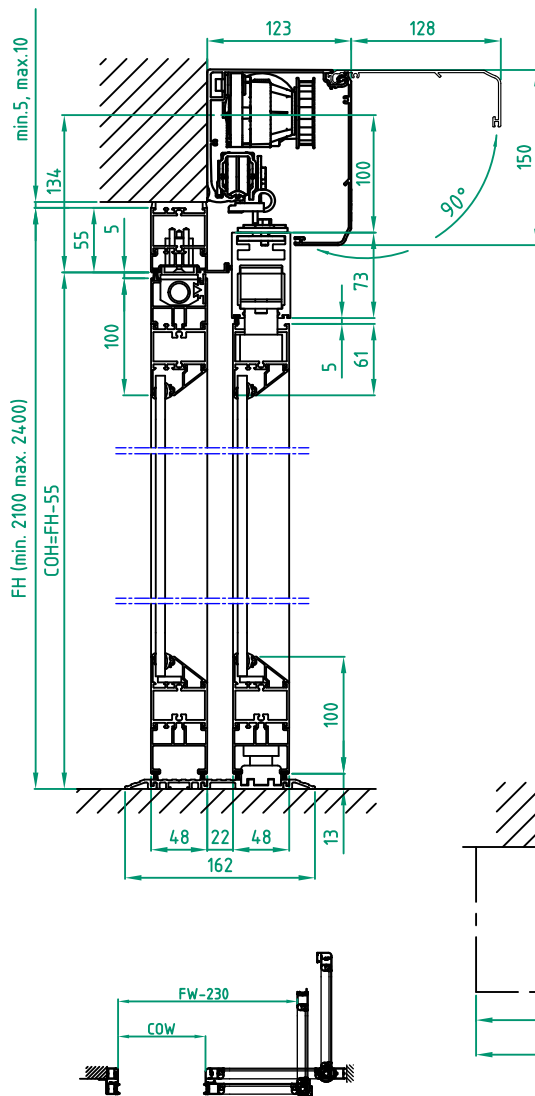

STATE WHEN ORDERING

FW = mm
FH = mm
X = mm
COW = mm
COH = mm
CL = mm

Surface treatment

☐ Silver anodized
Special anodized
RAL
Special powder coating
.....

Options see layers:

☐ Bottom rail 178
☐ Midrail 70, MH = mm
☐ Midrail 150, MH = mm

Glass option see drw. 1009026

Glass code:
.....

Limitation

If 22 mm glass FW x FH = max. 5,8 m²
If 40 mm glass FW x FH = max. 5,1 m²

Installation

☐ Floor heating
☐ Other

Customer:

Ref:

Door id:

Date:

Project No:

Sign:

Automatic door system
ASSA ABLOY Frame break-out 2 Panel wall mounted opening right
Art. No. 1009382-2PS-15
ASSA ABLOY SL500

ASSA ABLOY

6.0

1009382-EI

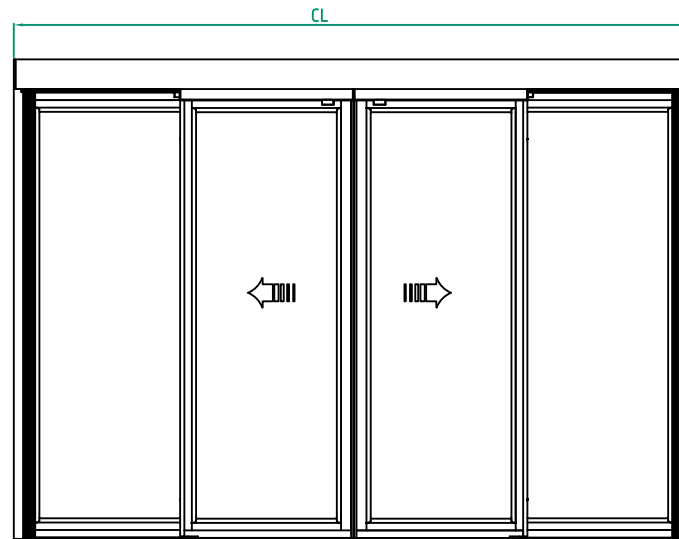
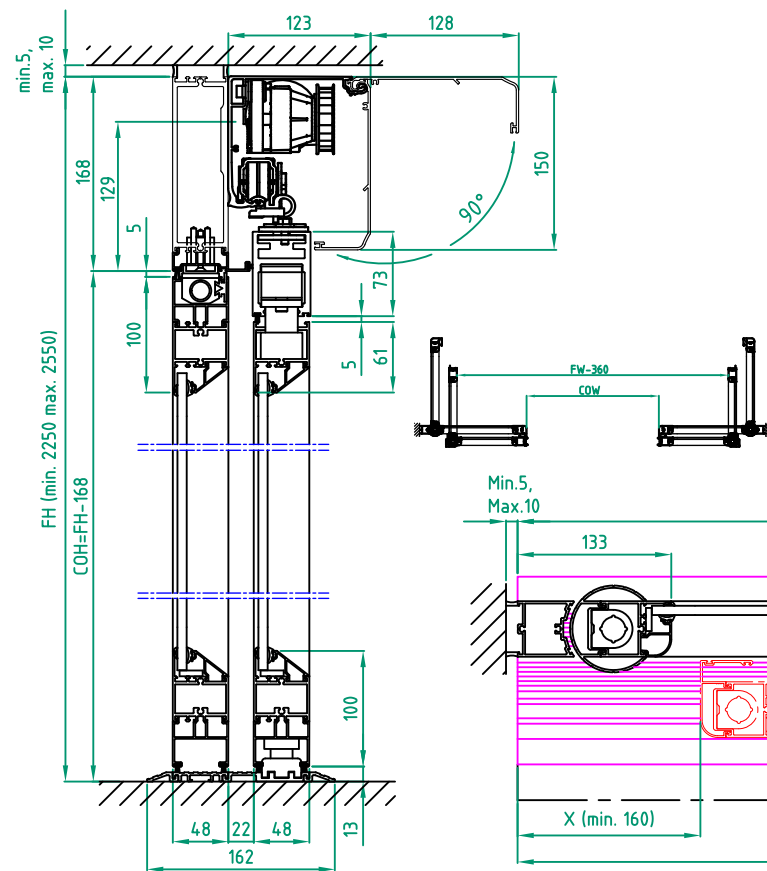

STATE WHEN ORDERING

FW = mm
FH = mm
X = mm
COW = mm
COH = mm
CL = mm

Surface treatment

☐ Silver anodized
Special anodized
RAL
Special powder coating

Options see layers:

☐ Bottom rail 178
☐ Midrail 70, MH = mm
☐ Midrail 150, MH = mm

Glass option see drw. 1009026

Glass code:

Limitation

If 22 mm glass FW x FH = max. 11,9 m²
If 40 mm glass FW x FH = max. 10,4 m²

Installation

☐ Floor heating
☐ Other

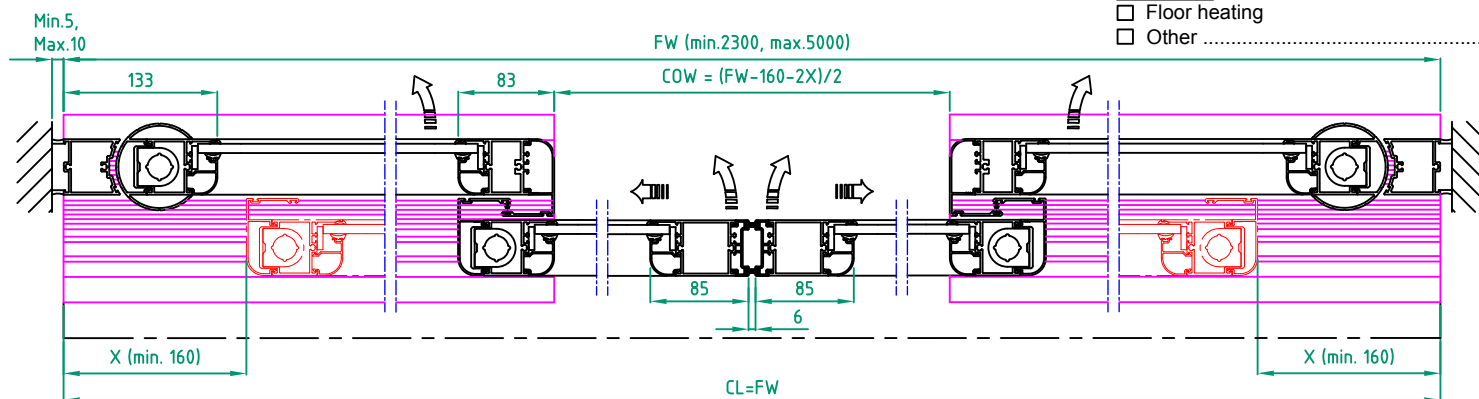

Customer:

Ref:

Door id:

Date:

Project No:

Sign:

Automatic door system
ASSA ABLOY Frame break-out 4 Panel beam mounted
Art. No. 1009382-4PB-15
ASSA ABLOY SL500

ASSA ABLOY

6.0 1009382-EI

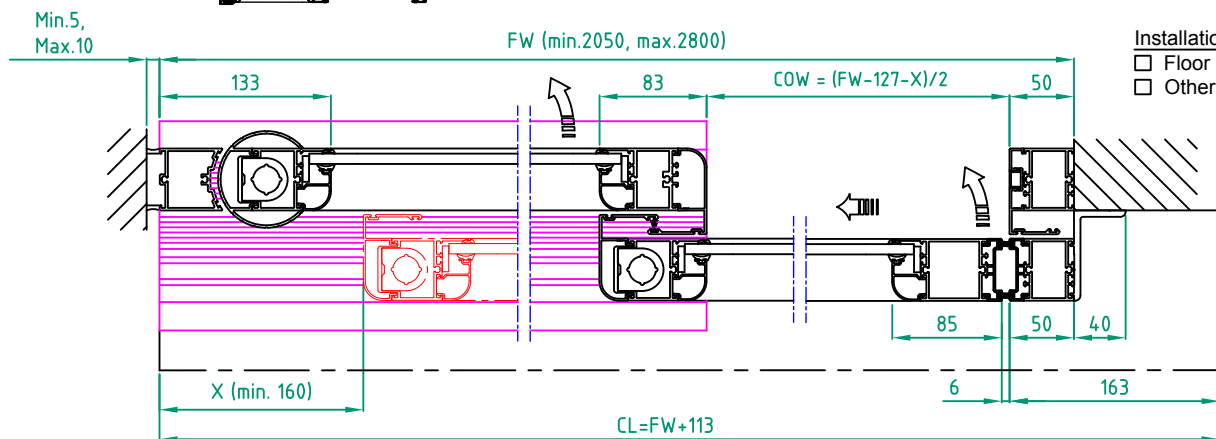
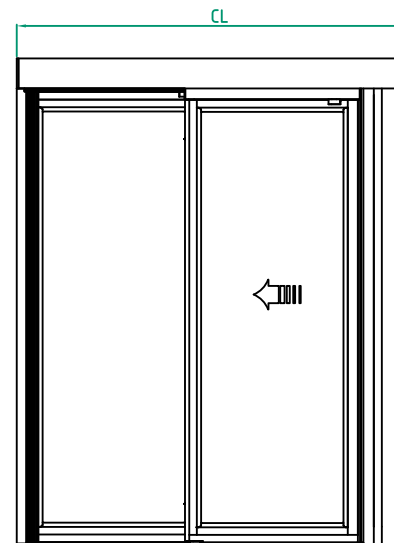
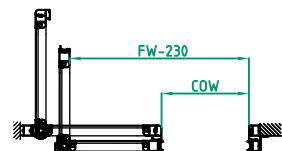
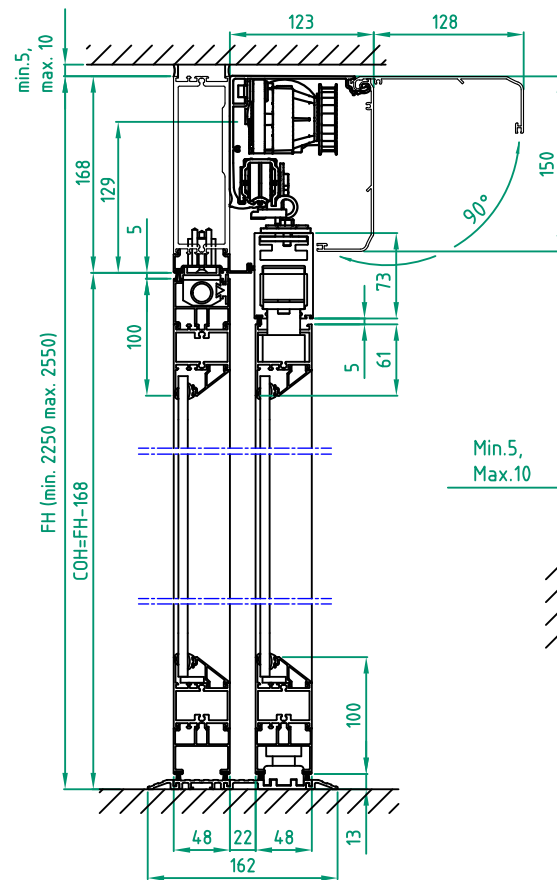

STATE WHEN ORDERING

FW = mm
FH = mm
X = mm
COW = mm
COH = mm
CL = mm

Surface treatment

☐ Silver anodized
Special anodized
RAL
Special powder coating

Options see layers:

☐ Bottom rail 178
☐ Midrail 70, MH = mm
☐ Midrail 150, MH = mm

Glass option see drw. 1009026

Glass code:

Limitation

If 22 mm glass FW x FH = max. 6,1 m²
If 40 mm glass FW x FH = max. 5,3 m²

Installation

☐ Floor heating
☐ Other

Customer:

Ref:

Door id:

Date:

Project No:

Sign:

Automatic door system
ASSA ABLOY Frame break-out 2 Panel beam mounted opening left
Art. No. 1009382-2PS-15
ASSA ABLOY SL500

ASSA ABLOY

6.0

1009382-EI

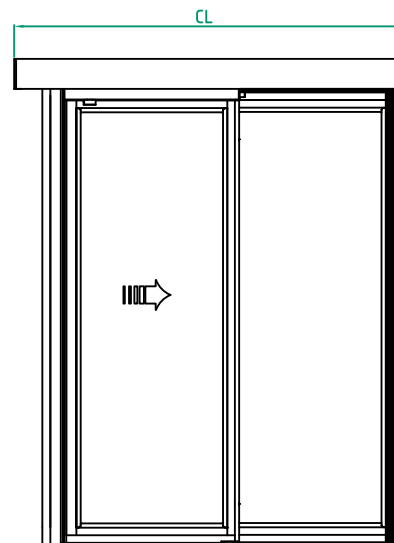
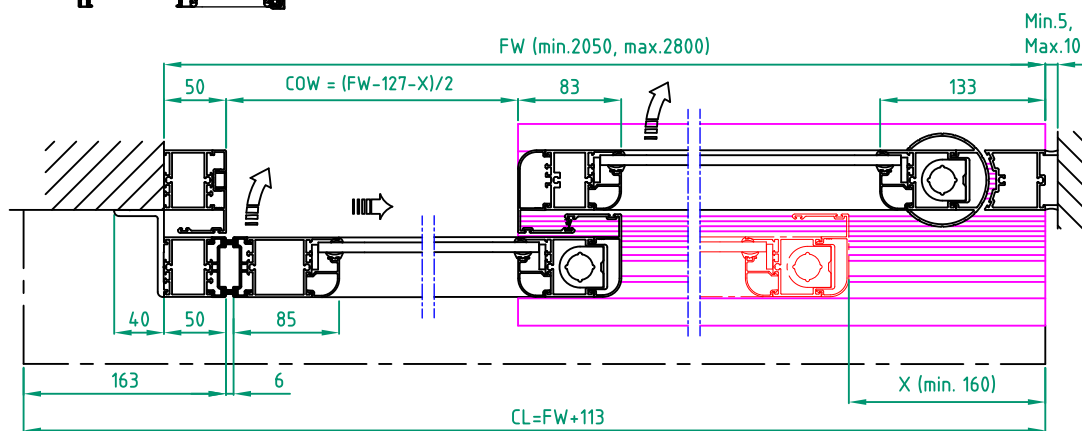
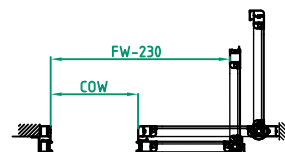
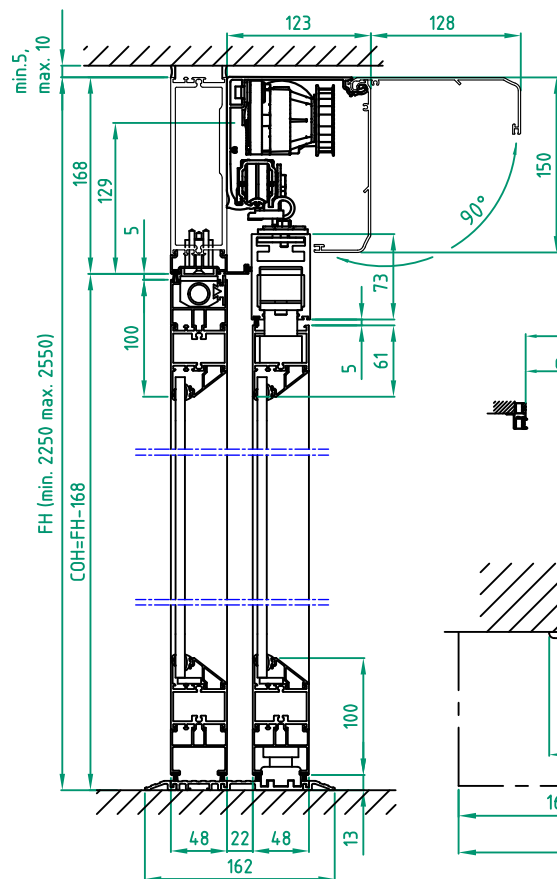

STATE WHEN ORDERING

FW = mm
FH = mm
X = mm
COW = mm
COH = mm
CL = mm

Surface treatment

☐ Silver anodized
Special anodized
RAL
Special powder coating

Options see layers:

☐ Bottom rail 178
☐ Midrail 70, MH = mm
☐ Midrail 150, MH = mm

Glass option see drw. 1009026

Glass code:

Limitation

If 22 mm glass FW x FH = max. 6,1 m²
If 40 mm glass FW x FH = max. 5,3 m²

Installation

☐ Floor heating
☐ Other

Customer:

Ref:

Door id:

Date:

Project No:

Sign:

Automatic door system
ASSA ABLOY Frame break-out 2 Panel beam mounted opening right
Art. No. 1009382-2PS-15
ASSA ABLOY SL500

ASSA ABLOY

6.0

1009382-EI